



TECHNICAL SPECIFICATIONS

ARKITEC PROGRAM BY ENVATECH

DATE 07.05.2026

COLOR PANELS	SMOOTH:	02-MLSB	WHITE
		02-MLSG1	LIGHT GRAY
		02-MLSG2	DARK GRAY
		02-MLS01	ALUMINUM
	WOOD:	02-MMAA	MAPLE
		02-MMAH	IS
ALUMINUM COLOR		08-ANPM	SILVER
		08-LA9011M	MATTE BLACK
		08-LA9010M	MATTE WHITE
		08-LA7012	GREY 7012
		08-ANIN*	INOX *
RUBBER COLOR (without aluminum)	Aluminum	Eraser	
	08-ANPM	4 PM	SILVER
	08-LA9011M	04-9011	BLACK
	08-LA9010M	04-9010	SILVER
	08-LA7012	04-9011	BLACK
	08-ANIN*	4 PM	BLACK
BLIND DOOR HARDWARE	07-BISTD	FLAT HINGES	
	07-POMEPM	POMO MERONI PLATA	
	07-POME9011	BLACK MERONI KNOB	
	07-MNOLPM	TESA OLA LEVER	
	07-MNTU-L*	TUBULAR LEVER *	
	07-MNTU-U*	TUBULAR "U" HANDLE *	
GLASS DOOR HARDWARE	07-BISTD05	SQUARE HINGES	
	07-POMEPM05	POMO MERONI PLATA	
	07-POME901105	BLACK MERONI KNOB	
	07-MNTU-U05*	TUBULAR "U" HANDLE *	
ASSEMBLIES	OPTION 1: Wall thickness 74 ÷ 100		
	OPTION 2: Wall thickness 100 ÷ 200 (*)		
	OPTION 3: Wall thickness > 200mm (*)		

(*) (Please inquire about price and delivery time)

BLIND DOOR PROGRAM

STANDARD

POMO MERONI



TESA OLA LEVER



OPTIONAL*

TUBULAR LEVER "L" * TUBULAR LEVER "U" *

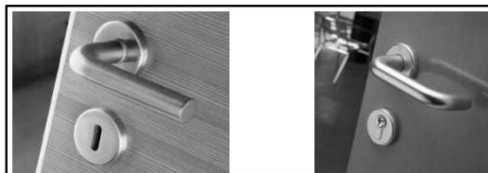

GLASS DOOR PROGRAM

POMO MERONI



TUBULAR "U" HANDLE OPTIONAL*



(*) OPTIONAL (Please inquire about price and delivery time)

Single leaf door 700mm



EPT701



EPT705

Single leaf door 800mm



EPT801

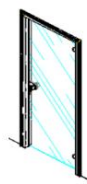

EPT805

Single leaf door 900mm



EPT901



EPT905

Door with hinged panel. Leaf dimensions: 800 + 300 mm



EPT1201



EPT1205

DOUBLE LEAF DOOR 800 + 800mm



EPT1701



EPT1705

NOTE: All door leaves are 2030mm high. For sizes other than this, please inquire about price and delivery time.

DETAILS

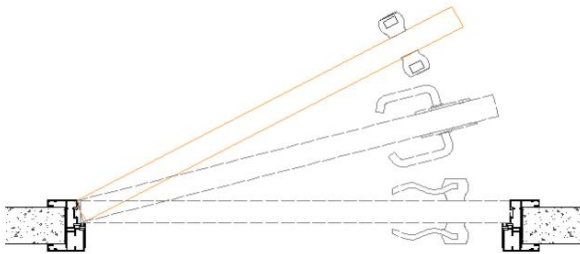

BLIND DOOR

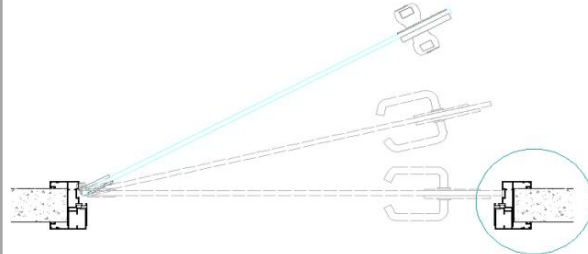

GLASS DOOR

MOUNTING OPTIONS

ASSEMBLY OPTION 1.0

Mounting for existing wall thickness of 70 to 100mm

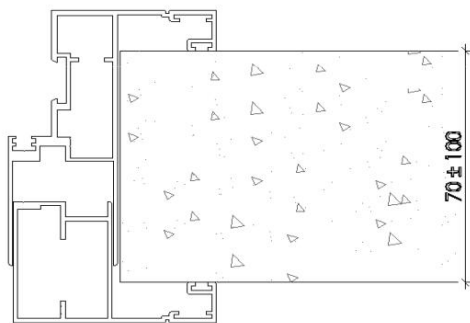

SINGLE-LEAF DOOR

Door leaf 725
h. 1200mm / 2030mm
2030mm 925 x h.
2030mm

Work light 790
h. 1200mm / 2075mm
2075mm 990 x h.
2075mm

DOUBLE DOOR

Door leaf 825 /
290 x h. 2030mm 1184 x h. 2075mm
Construction light
825 / 825 x h.
2030mm 1718 x h. 2075mm

ASSEMBLY OPTION 2.0

OPTION 2.1: Mounting for wall thickness from 100 to 130mm

OPTION 2.2: Mounting for wall thickness from 130 to 160mm

OPTION 2.3: Mounting for wall thickness from 160 to 190mm

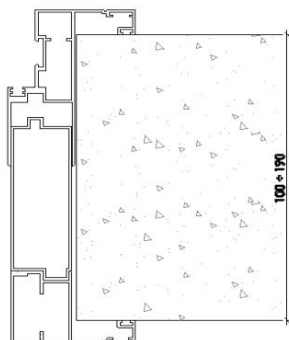

SINGLE-LEAF DOOR

Door leaf 725
x h. 2030mm 825 x
h. 2030mm 925 x h.
2030mm

Work light 790
x h. 2075mm 890 x
h. 2075mm 990 x h.
2075mm

DOUBLE DOOR

Door leaf 825 /
290 x h. 2030mm 1184 x h. 2075mm
Construction light
825 / 825 x h.
2030mm 1718 x h. 2075mm

ASSEMBLY OPTION 1.0 AND 2.0

For mounting according to option 1.0 and 2.0, a minimum base of 30mm of wall/plasterboard is required vertically and horizontally.

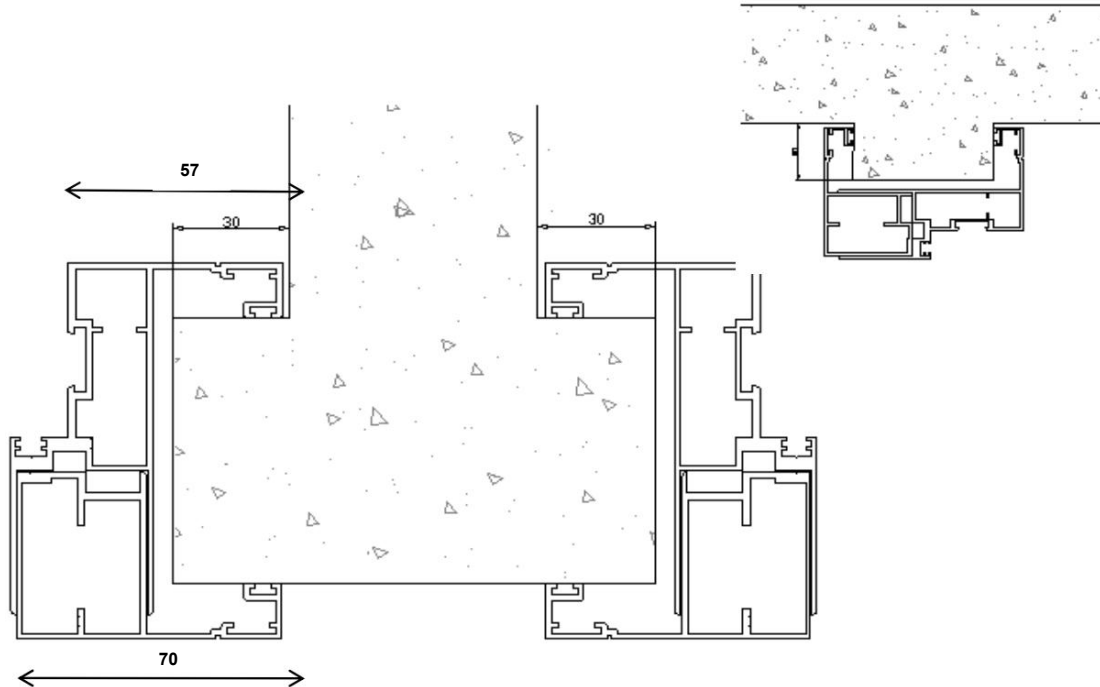

ASSEMBLY OPTION 3.0

OPTION 3.0: Mounting for thicknesses from 100mm
Mounting with pine subframe.

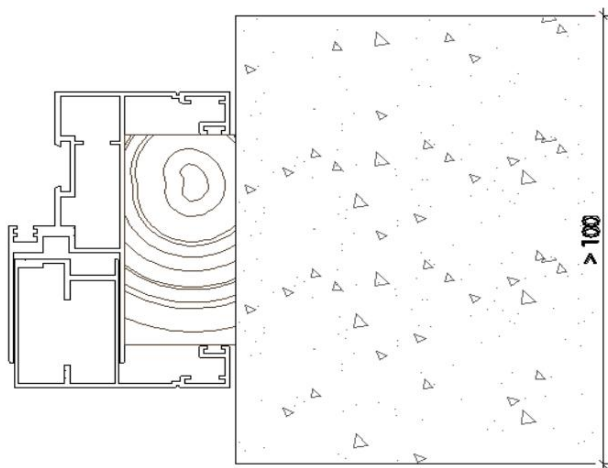

SINGLE-LEAF DOOR

Door leaf 725
x h. 2030mm 825 x
h. 2030mm 925 x h.
2030mm

Work light 854
x h. 2097mm 954 x
h. 2097mm 1054 x h.
2097mm

DOUBLE DOOR

Door leaf 825 /
290 x h. 2030mm 1248 x h. 2097mm 825 / 825 x h.
2030mm 1782 x h. 2097mm

Construction light

Signed: PRODUCTION	Commercial Signature	Signed: TECHNICAL OFFICE
DATE	DATE	DATE